

# SV186BPH - CONSTRUCTION DRAWINGS

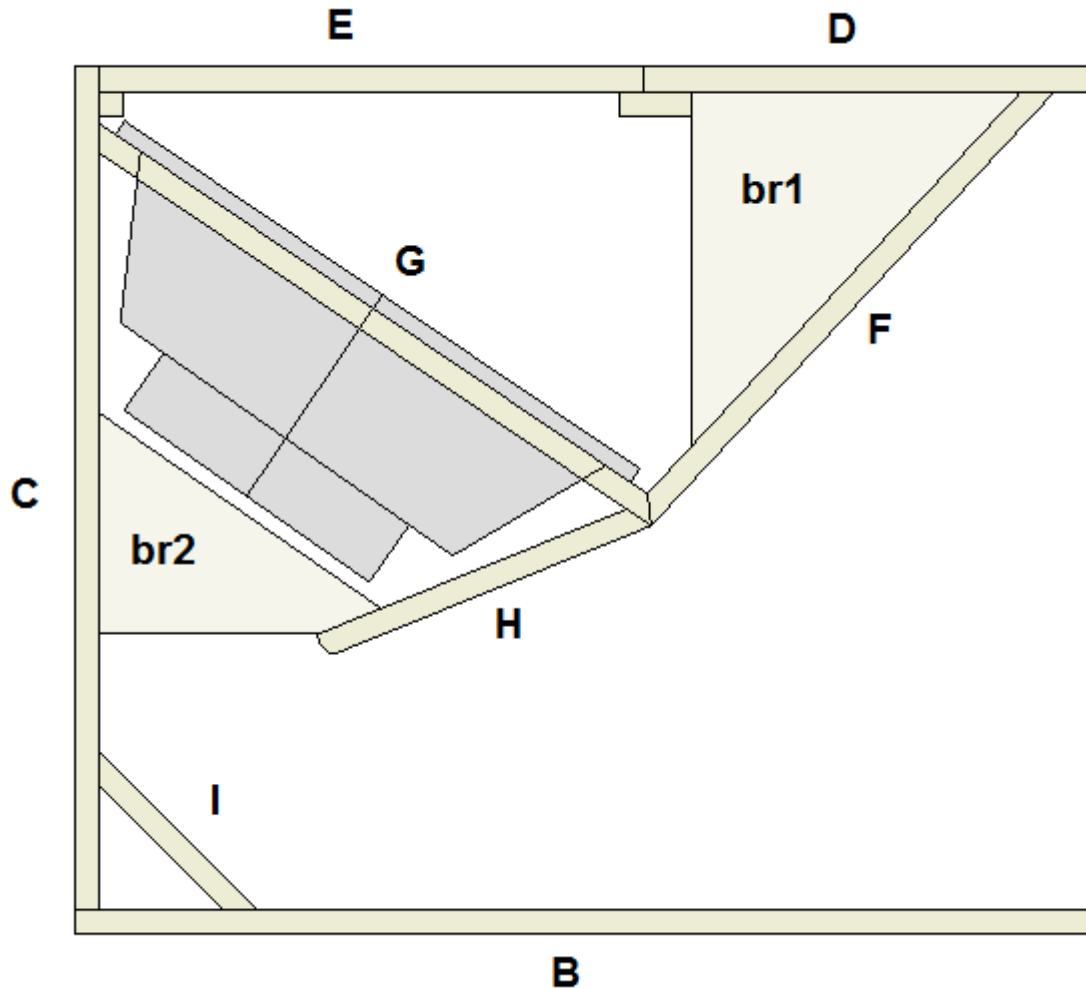

ID	HxW (mm)	Qty.	Angles	Note
A	750 x 636	2	90 === 90	Sides (Not shown on the drawing)
B	750 x 564	1	90 === 90	
C	618 x 564	1	90 === 90	
D	330 x 564	1	90 === 90	
E	400 x 562	1	90 === 90	Leaves 1mm around access panel
F	435 x 564	1	49.5/===\47.1	Angles don't need to be <u>that</u> precise
G	501.4 x 564	1	56\===\49.5	Cut hole for speaker (PD: Ø=414mm)
H	258 x 564	1	56\===J90	Round one corner (see drawing)
I	170 x 564	1	45\===/45	

Bracings br1 & br2 are double with uniform spacing. Bracings can be made from diagonally cut rectangles with the dimensions: [br1 : 260 x 241.5.] & [br2 : 222 x 150]. (Optional, compensate for loss due to blade thickness.)

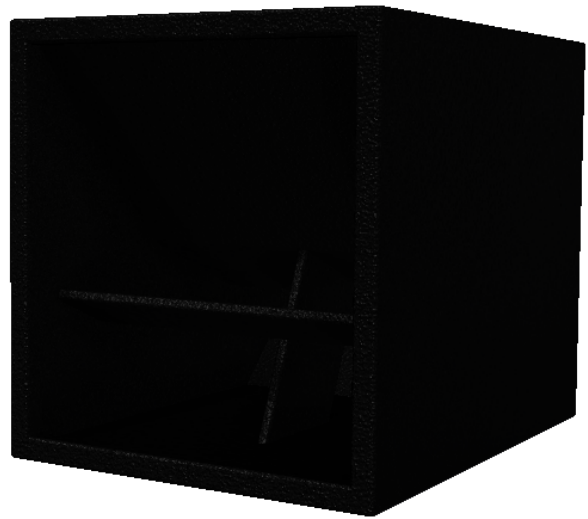
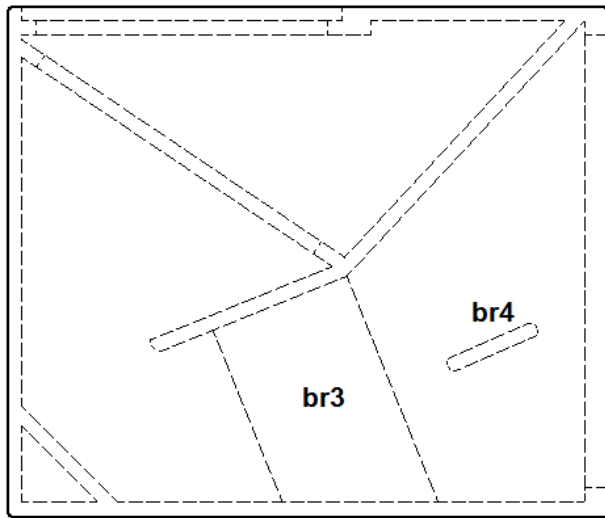

Bracing br3 can be made from a rectangle with the dimensions: 303 x 180; where one corner is then cut off in a  $68^\circ$  angle. Bracing br4 can be made from a rectangle with the dimensions: 564 x 120.

30 mm reinforcement battens in the mouth is recommended. (Optional, subtract thickness of speaker grill.)

Dimensions for construction:

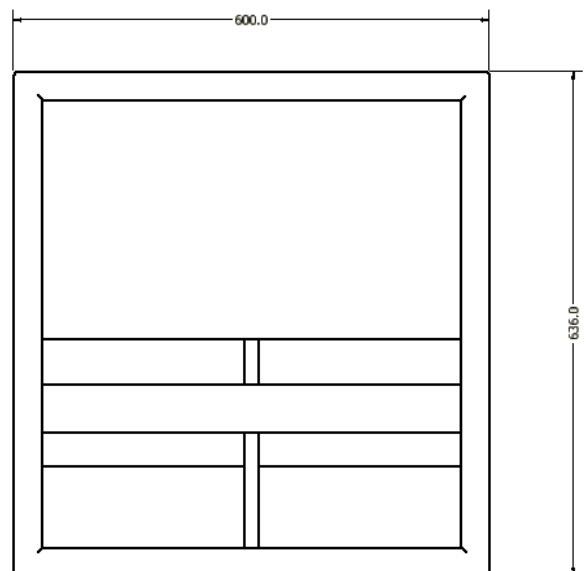
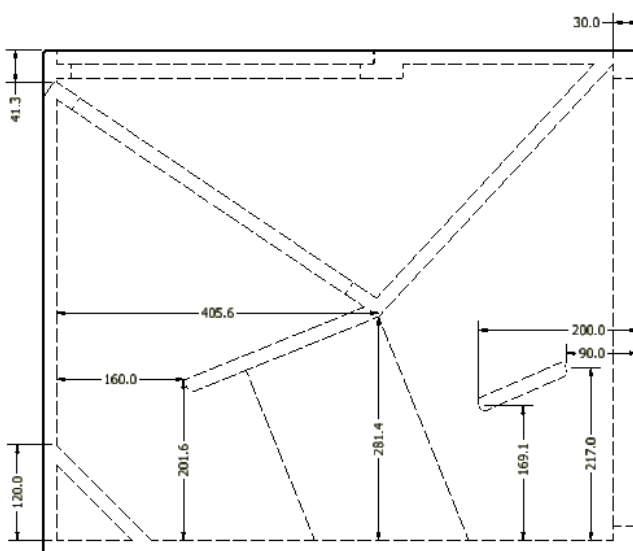

A more detailed view can be seen on the next pages.

Most suited material for construction is 18mm void-free 13-laminate birch plywood.

